



DFS4(A/H) – System DFC4(A/H)3 – Outdoor DFF4(A/H)H – Indoor Product Specifications

DUCT FREE SPLIT SYSTEM HIGH WALL

Efficient 13 SEER Air Conditioners and
7.7 HSPF Heat Pumps

¾ THRU 2 TONS

- Rotary compressors in all models
- Wireless remote for enhanced functionality
- Programmable time/temperature settings
- Sleep mode
- Diagnostics
- Auto-Swing louvers
- Compressor lockout protection
- 115 volt on ¾ and 1 ton models
- Factory charged with R-410A refrigerant



Rated in accordance with ARI Standard 210 and/or 240. Certification applies only when used with proper components as listed with ARI.

Air Conditioners		
System Model Number		
Outdoor Section	Size (tons)	Dimensions W x H x D in. (mm)
Indoor Section		
DFS4A309J1A		
DFC4A309J1A	¾	30.71 x 21.26 x 10.87 (780 x 540 x 276)
DFF4AH09J1A	¾	32.09 x 11.02 x 7.68 (815 x 280 x 195)
DFS4A312J1A		
DFC4A312J1A	1	29.92 x 23.23 x 11.42 (760 x 590 x 290)
DFF4AH12J1A	1	35.67 x 11.26 x 9.25 (906 x 286 x 235)
DFS4A318K1A		
DFC4A318K1A	1½	33.07 x 27.36 x 13.19 (840 x 695 x 335)
DFF4AH18K1A	1½	49.21 x 12.80 x 9.06 (1250 x 325 x 230)
DFS4A324K1A		
DFC4A324K1A	2	31.16 x 33.86 x 13.11 (893 x 860 x 333)
DFF4AH24K1A	2	49.21 x 12.80 x 9.06 (1250 x 325 x 230)

Heat Pumps		
System Model Number		
Outdoor Section	Size (tons)	Dimensions W x H x D in. (mm)
Indoor Section		
DFS4H309J1A		
DFC4H309J1A	¾	30.71 x 21.26 x 10.87 (780 x 540 x 276)
DFF4HH09J1A	¾	32.09 x 11.02 x 7.68 (815 x 280 x 195)
DFS4H312J1A		
DFC4H312J1A	1	29.92 x 23.23 x 11.42 (760 x 590 x 290)
DFF4HH12J1A	1	35.67 x 11.26 x 9.25 (906 x 286 x 235)
DFS4H318K1A		
DFC4H318K1A	1½	33.07 x 27.36 x 13.19 (840 x 695 x 335)
DFF4HH18K1A	1½	49.21 x 12.80 x 9.06 (1250 x 325 x 230)
DFS4H324K1A		
DFC4H324K1A	2	31.16 x 33.86 x 13.11 (893 x 860 x 333)
DFF4HH24K1A	2	49.21 x 12.80 x 9.06 (1250 x 325 x 230)

Specifications subject to change without notice.

Required Clearances

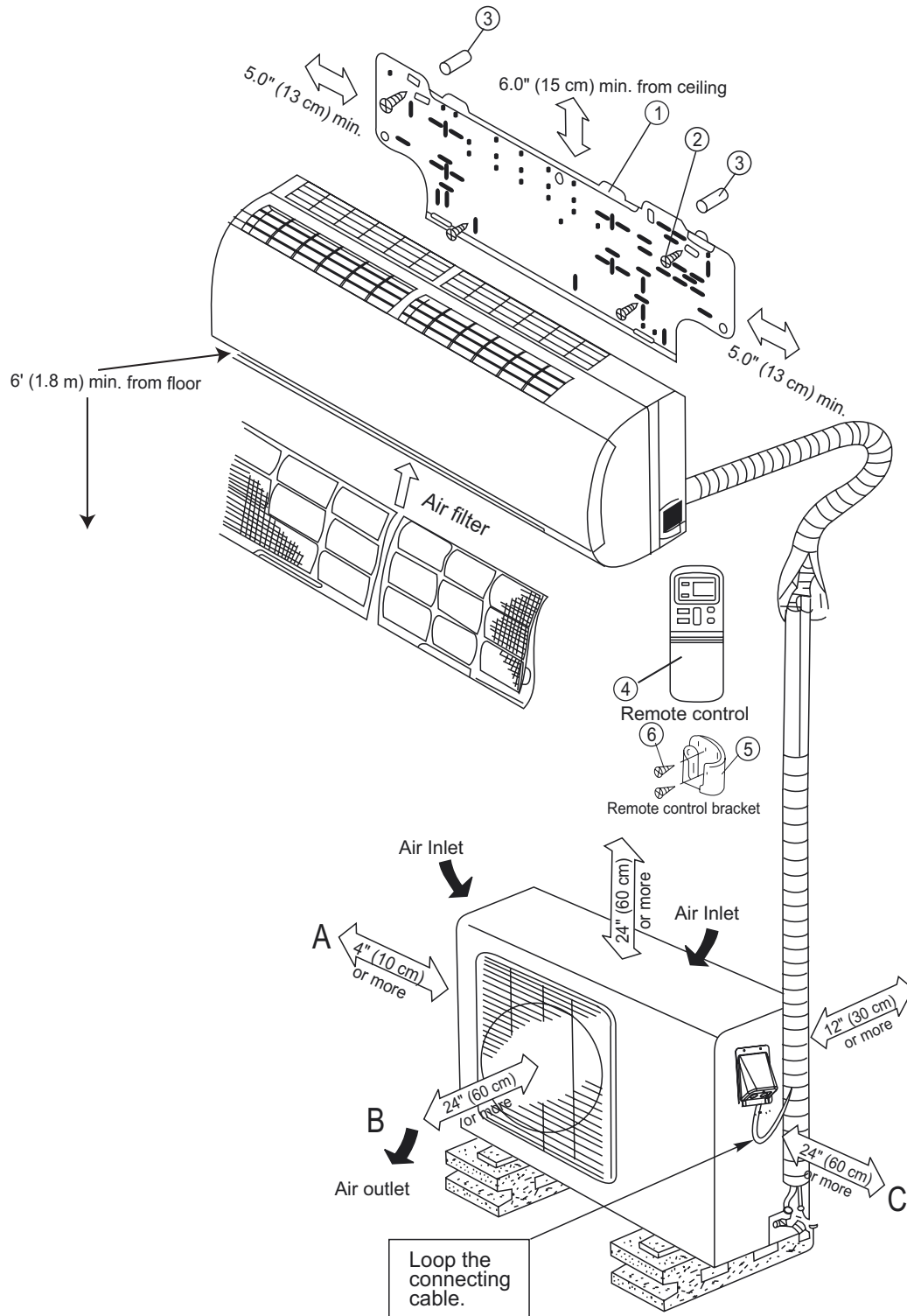
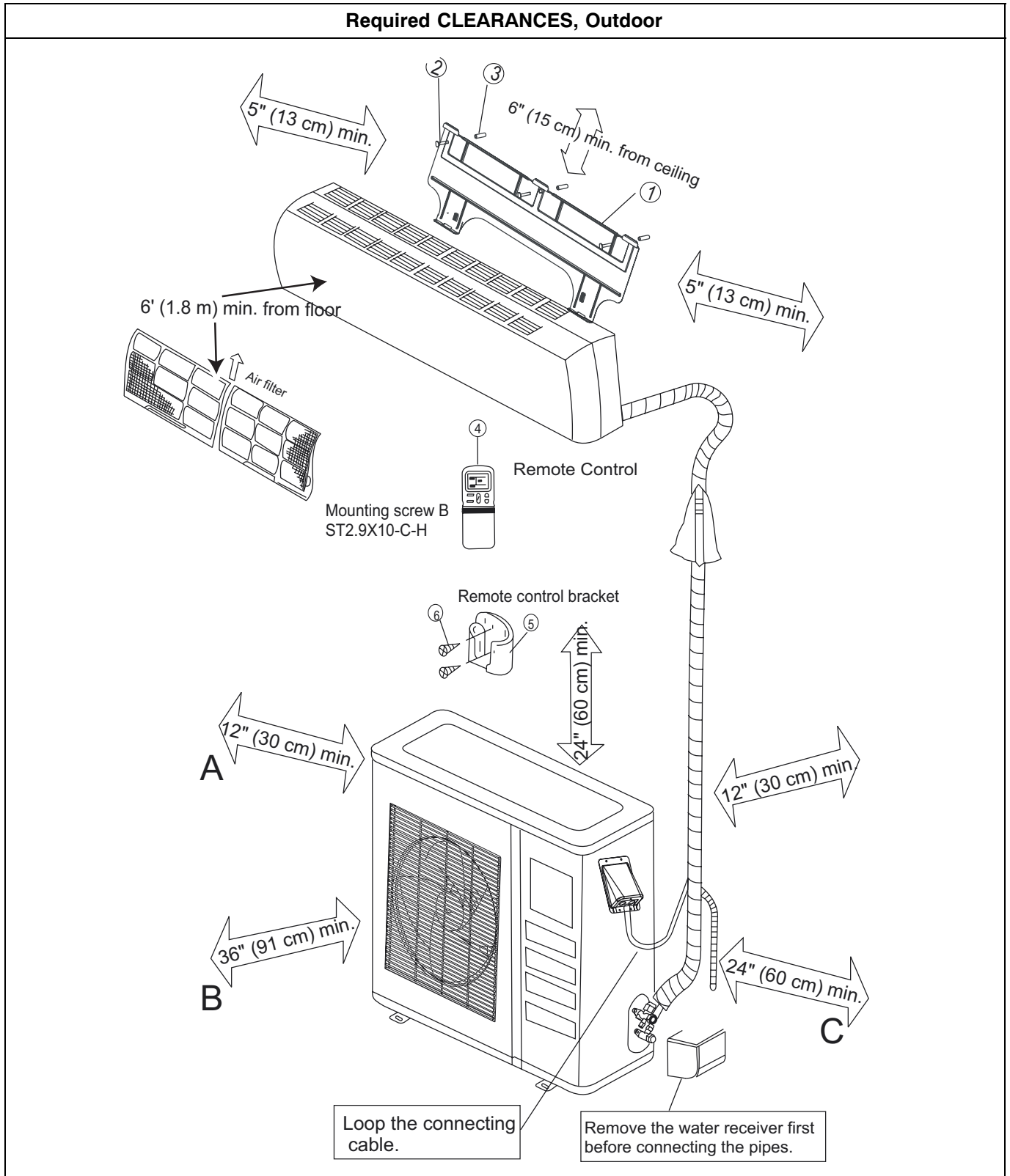

Fig. 1 – DFF4(A/H)H/DFC4(A/H)3 09-12
Parts List and Clearances

Note:

- If the outdoor unit is higher than the indoor unit, prevent rain from flowing into the indoor unit along the connection pipe by making a downward arc in the connection pipe before it enters the wall to the indoor unit. This will ensure that rain will drip from the connection pipe before it enters the wall.
- The illustration above is only a sketch. Different models may be slightly different.



Note:

- If the outdoor unit is higher than the indoor unit, prevent rain from flowing into the indoor unit along the connection pipe by making a downward arc in the connection pipe before it enters the wall to the indoor unit. This will ensure that rain will drip from the connection pipe before it enters the wall.
- The illustration above is only a sketch. Different models may be slightly different.

DIMENSIONS

INDOOR

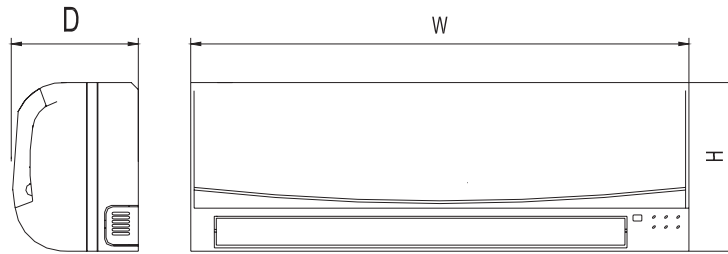

Model Size	W in. (mm)	H in. (mm)	D in. (mm)	Weight lb (kg)
9K	32.09 (815)	11.02 (280)	7.68 (195)	24.2 (11)
12K	35.67 (906)	11.26 (286)	9.25 (235)	33.0 (15)
18K	49.21 (1250)	12.80 (325)	9.06 (230)	55.0 (25)
24K	49.21 (1250)	12.80 (325)	9.06 (230)	55.0 (25)

OUTDOOR

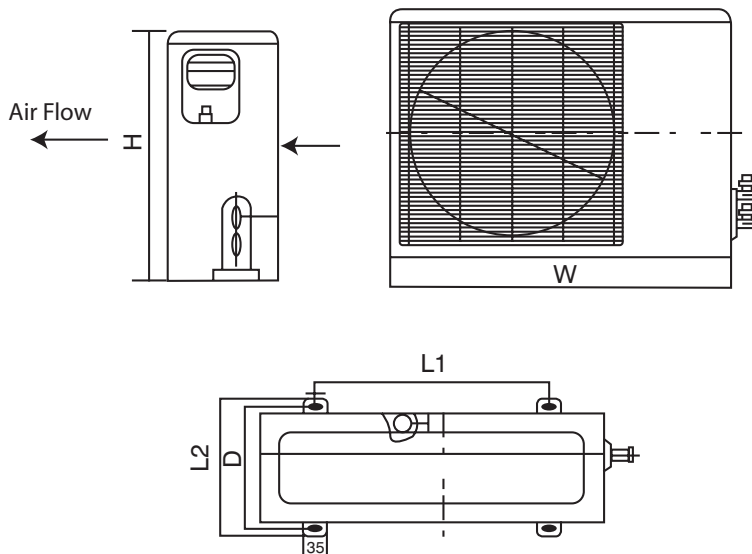

Model Size	W in. (mm)	H in. (mm)	D in. (mm)	L1 in. (mm)	L2 in. (mm)	Weight lb (kg) Cooling Only	Weight lb (kg) Heat Pumps
9K	30.71 (780)	21.26 (540)	10.87 (276)	21.61 (549)	11.81 (300)	77.0 (35)	79.2 (36)
12K	29.92 (760)	23.23 (590)	11.42 (290)	20.87 (530)	12.40 (315)	85.8 (39)	90.2 (41)
18K	33.07 (840)	27.36 (695)	13.19 (335)	22.05 (560)	14.17 (360)	125.4 (57)	125.4 (57)
24K	31.16 (893)	33.86 (860)	13.11 (333)	23.11 (588)	13.98 (355)	159.5 (72)	160.6 (73)

SERVICE VALVE LOCATIONS

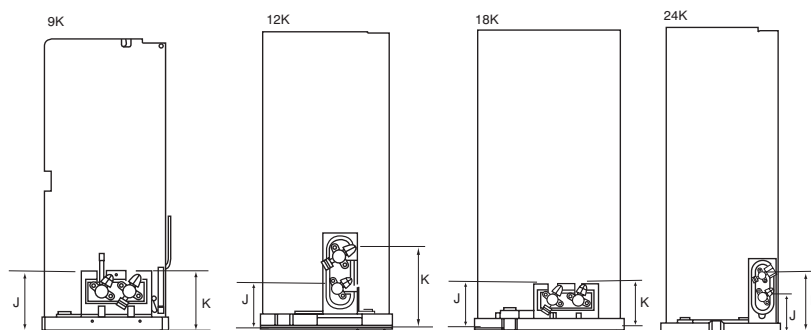

Service Valve Locations	9K in. (mm)	12K in. (mm)	18K in. (mm)	24K in. (mm)
J	3.46 (88)	3.19 (81)	3.46 (88)	4.02 (102)
K	3.46 (88)	5.63 (143)	3.62 (92)	6.57 (167)

Outdoor Model Size	09J1A	12J1A	18K1A	24K1A
Indoor Model Size	09J1A	12J1A	18K1A	24K1A
PHYSICAL DATA – Air Conditioner				
Cooling Capacity (BTU/hr)	9,200	11,400	17,500	tba
SEER	13.0	13.0	13.0	13.0
Moisture Removal Gallons/hr (Liters/hr)	.24 (0.9)	.36 (1.35)	.41 (1.55)	.53 (2.0)
Indoor Fan CFM (High speed)	325	425	630	tba
Indoor Sound Rating (dBA High - dBA Low)	53 - 39	58 - 51	59 - 54	tba
Outdoor Sound Rating (dBA)	65	65	68	tba
Liquid Line Connection Size (in.)	1/4	1/4	1/4	3/8
Vapor Line Connection Size (in.)	3/8	1/2	1/2	5/8
Maximum Vertical Separation (ft.) Indoor Higher than Outdoor	35	35	50	60
Maximum Vertical Separation (ft.) Indoor Lower than Outdoor	35	35	50	60
Maximum Line-set Length (ft.)	65	65	100	100
Factory Charge R-410A (lbs.)	2.3	2.9	4.4	tba
Net Weight, Outdoor Lbs. (Kg)	70.5 (32)	79.4 (36)	117 (53)	150 (68)
Net Weight, Indoor Lbs. (Kg)	17.6 (8)	25.4 (11.5)	39.7 (18)	39.7 (18)
OUTDOOR ELECTRICAL DATA – Air Conditioner				
Required Supply Voltage	115-1-60 AC		208/230-1-60 AC	
Minimum Circuit Ampacity - MCA (amps)	12	15	11	14
Maximum OverCurrent Protective device - MOCP (amps)	20	25	20	25
Compressor RLA (Rated Load Amps) LRA (Locked Rotor Amps)	7.5 40	9.9 47	7.3 32.6	9.7 34.8
Fan Motor Amps	0.69	0.69	0.78	0.62
INDOOR ELECTRICAL DATA – Air Conditioner				
Required Supply Voltage	35 DC		208/230-1-60 AC	
FLA (Full Load Amps)	1.1	1.18	0.26	0.39

Outdoor Model Size	09J1A	12J1A	18K1A	24K1A
Indoor Model Size	09J1A	12J1A	18K1A	24K1A
PHYSICAL DATA – Heat Pump				
Cooling Capacity (BTU/hr)	9,600	11,500	tba	tba
SEER	13.0	13.0	13.0	13.0
Heating Capacity (BTU/hr)	9,400	11,500	tba	tba
HSPF	7.7	7.7	tba	tba
Moisture Removal Gallons/hr (Liters/hr)	.24 (0.9)	.36 (1.35)	.41 (1.55)	.53 (2.0)
Indoor Fan CFM (High speed)	325	425	tba	tba
Indoor Sound Rating (dBA High – dBA Low)	54 – 42	59 – 47	tba	tba
Outdoor Sound Rating (dBA)	66	64	tba	tba
Liquid Line Connection Size (in.)	1/4	1/4	1/4	3/8
Vapor Line Connection Size (in.)	3/8	1/2	1/2	5/8
Maximum Vertical Separation (ft.) Indoor Higher than Outdoor	35	35	50	60
Maximum Vertical Separation (ft.) Indoor Lower than Outdoor	35	35	50	60
Maximum Line-set Length (ft.)	65	65	100	100
Factory Charge R-410A (lbs.) *	2.4	3.0	tba	tba
Net Weight, Outdoor Lbs. (Kg)	72.8 (33)	83.8 (38)	117 (53)	151 (68.5)
Net Weight, Indoor Lbs. (Kg)	17.6 (8)	25.4 (11.5)	39.7 (18)	39.7 (18)
OUTDOOR ELECTRICAL DATA – Heat Pump				
Required Supply Voltage	115-1-60 AC		208/230-1-60 AC	
Minimum Circuit Ampacity – MCA (amps)	12	15	11	14
Maximum OverCurrent Protective device – MOCP (amps)	20	25	20	25
Compressor RLA (Rated Load Amps) LRA (Locked Rotor Amps)	7.5 40	9.9 47	7.3 32.6	9.7 34.8
Fan Motor Amps	0.69	0.69	0.78	0.62
INDOOR ELECTRICAL DATA – Heat Pump				
Required Supply Voltage	35 DC		208/230-1-60 AC	
FLA (Full Load Amps)	1.1	1.18	0.26	0.39

ACCESSORIES		
Part Number	Description	Used On Model Size
NADA001DK	Condensate Pump	9, 12
NADA002DK	Condensate Pump	18, 24
NADA002LA	Low Ambient Kit *	ALL
NADA001CH	Crankcase Heater (120V)	9, 12
NADA002CH	Crankcase Heater (240V)	18, 24
1173540	Isolation Relay (120V) *	9, 12
1174662	Isolation Relay (240V) *	18, 24

* When Low Ambient Kit is used with Heat Pump, additional Isolation Relay is required.

DUCT FREE SPLIT SYSTEM MODEL NUMBER IDENTIFICATION GUIDE – OUTDOOR

	DFC	4	A	3	09	J	1	A
DFC = Duct Free Condenser								
DFS = Duct Free System								
4 = Environmentally Sound R-410A		REFRIGERANT						
A = Air Conditioner								
H = Heat Pump				TYPE				
3 = 13								
4 = 14				NAMEPLATE SEER				
09 = 9,000 BTUH = ¾ ton								
12 = 12,000 BTUH = 1 ton								
18 = 18,000 BTUH = 1½ tons								
24 = 24,000 BTUH = 2 tons				NOMINAL CAPACITY				
J = 115-1-60								
K = 208/230-1-60						SUPPLY VOLTAGE		
1 = Single Zone								
2 = Dual Zone								
3 = Tri Zone						SALES CODE / FEATURES		
Sales Code								

DUCT FREE SPLIT SYSTEM MODEL NUMBER IDENTIFICATION GUIDE – INDOOR

	DFF	4	A	H	09	J	1	A
DFF = Duct Free Fan Coil								
DFS = Duct Free System								
4 = Environmentally Sound R-410A		REFRIGERANT						
A = Air Conditioner								
H = Heat Pump				TYPE				
H = High Wall								
U= Under Ceiling								
C = Cassette				APPLICATION				
09 = 9,000 BTUH = ¾ ton								
12 = 12,000 BTUH = 1 ton								
18 = 18,000 BTUH = 1½ tons								
24 = 24,000 BTUH = 2 tons				NOMINAL CAPACITY				
J = 115-1-60								
K = 208/230-1-60						SUPPLY VOLTAGE		
1 = Single Zone								
2 = Dual Zone								
3 = Tri Zone						SALES CODE / FEATURES		
Sales Code								